

Surplus Car Park, Asda, Merthyr Tydfil

**Drive-Thru's or Units Up To 20,000 sq ft
Freehold / Occupational Leasehold**

Macarthur
••• Wilson

Retail Property Consultants

0117 908 3350

Location

The site itself is on the North East side of Merthyr which has a town population of 55,000 and is easily accessible from the Heads of the Valley Road A465 and the Eastern Ring Road the A4060.

The store has a weekly customer count of in excess of 40,000 which will act as a good year round draw for other commercial uses on this site.

Accommodation

The site is in an extremely prominent location next to Asda's main car park and comprises 1.514 acres of land. This will support a number of drive thru or units up to 20,000 sq ft, together with car parking on site as well as the adjacent main Car Park.

Terms

Expressions of interest on either a freehold or occupational leasehold basis are invited.

Rent

Upon application.

Legal Costs

Each party is to be responsible for their own legal costs incurred in the transaction.

VAT

All figures quoted are exclusive of VAT, where applicable.

Further Information

For further information or to arrange an appointment to view please contact;

Richard Macarthur

07957 360 923

rgm@macarthurwilson.com

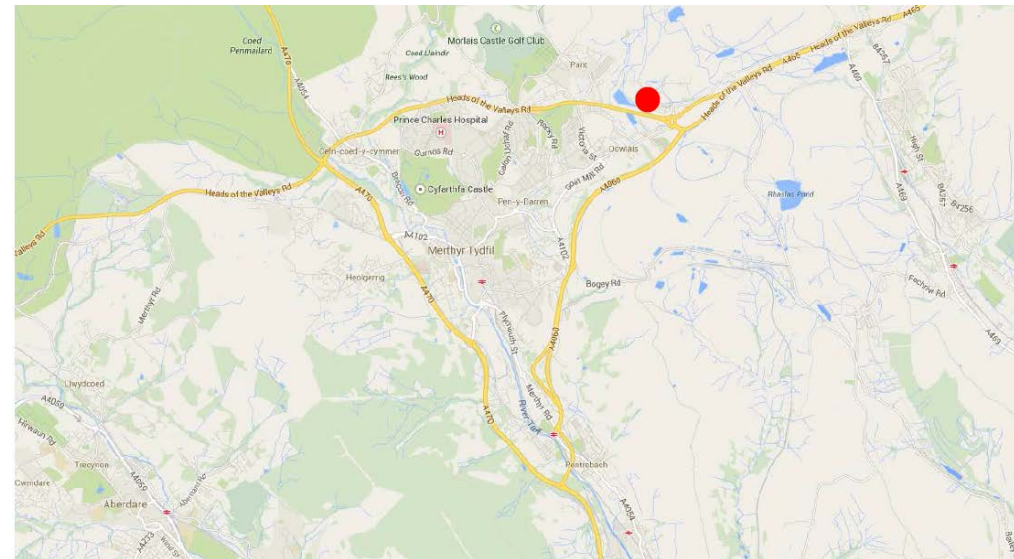

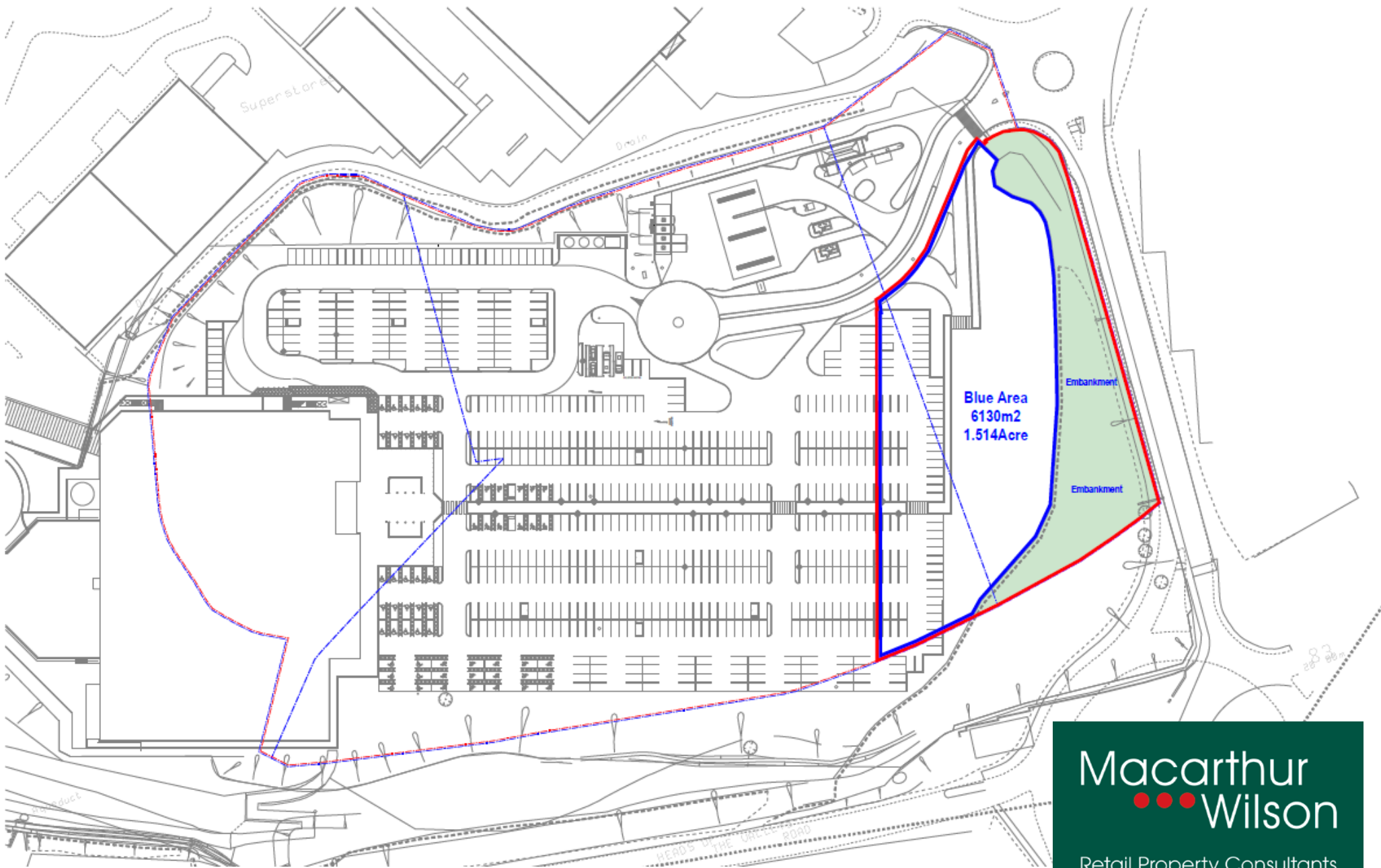

Subject to Contract and Planning Permission

Notice:
These particulars are believed to be correct, but their accuracy is not guaranteed and they do not form part of any contract.

**Macarthur
Wilson**
Retail Property Consultants

0117 908 3350
macarthurwilson.com

Surplus Car Park, Asda, Merthyr Tydfil